



iCDM

INDUSTRIAL COOLING DISTRIBUTION MODULE

The ATS iCDM, is a liquid loop in a single stand alone system. The system is a single, ventilated box, containing a pump, heat exchanger, reservoir and controls. Simply attach the cold plate or other heat removal mechanism and your liquid loop is ready for deployment.

iCDM is available in a 10kW and a 20kW



Features & Benefits

- Temperature control by adjusting the flow manually using system VFD control
- Environmentally friendly
- Localized cooling once attached to a cold plate
- Fast temperature response for cooling

Applications

- Laser cooling
- Laboratory test equipment
- Medical diagnostic equipment
- Analytical equipment
- Defense & aerospace
- Semiconductor equipment
- Computer server liquid cooling

Connect your liquid loop with iCDM

Wetted Materials

- Aluminum
- EPDM
- Stainless Steel
- Polycarbonate
- Polypropylene
- Polyurethane
- Nylon 11
- Santoprene

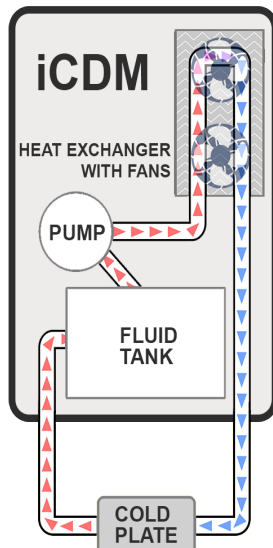

iCDM 10kW or 20kW



Tubed, Finned & Custom Cold Plates

- » **COOLING CAPACITY**
iCDM-10 10kW
iCDM-20 20kW
- » **PUMP PRESSURE HEAD MAX**
70 m (100 psi / 230 ft)
- » **PUMP FLOW RATE**
22 l/min (5.8 GPM)
- » **WATER TANK CAPACITY**
2 L (1/2 gallon)
- » **FLUID LOOP ATTACH**
1/2 inch NPT, stainless Steel
- » **INPUT POWER**
115V AC
- » **POWER INPUT CURRENT**
20 A
- » **FREQUENCY RANGE**
60 Hz
- » **OPERATING TEMPERATURE RANGE**
20 TO 65° C (65 TO 149° F)
- » **OPERATING HUMIDITY RANGE**
20 to 90% RH
- » **TEMPERATURE STABILITY**
+ / - 1° C
- » **STORAGE TEMPERATURE**
-40 to +85° C (-40 to 185° F)
- » **STORAGE HUMIDITY**
10 to 95%
- » **DIMENSIONS iCDM-10 & iCDM-20 (LxWxH)**
550x800x574.5 mm (21.6x31.5x22.6 in)



Main Features of the iCDM-10kW and iCDM-20kW details below applies to both systems

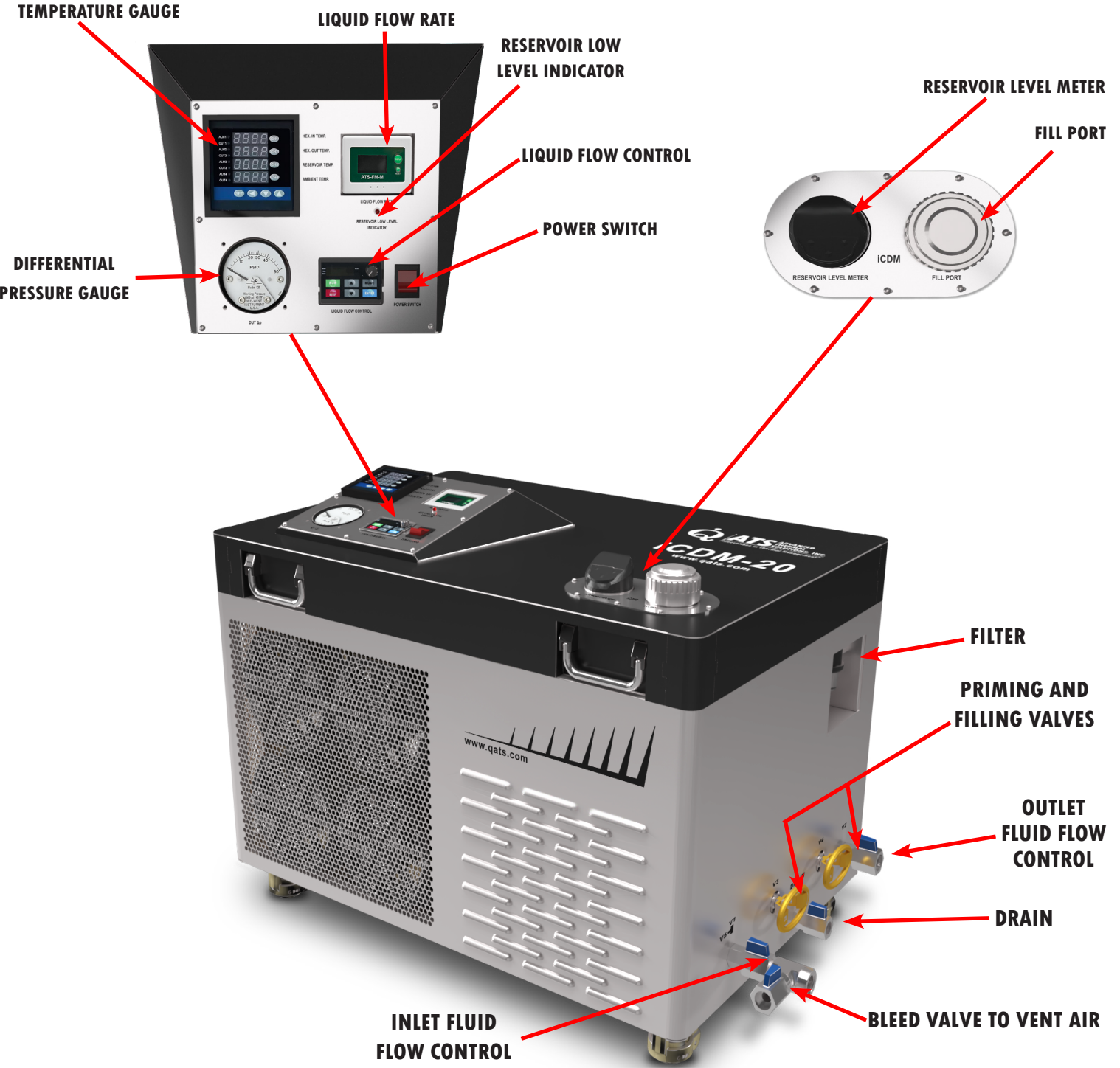

Contact us for your custom design requirements @ ats-hq@qats.com



iCDM Application Examples

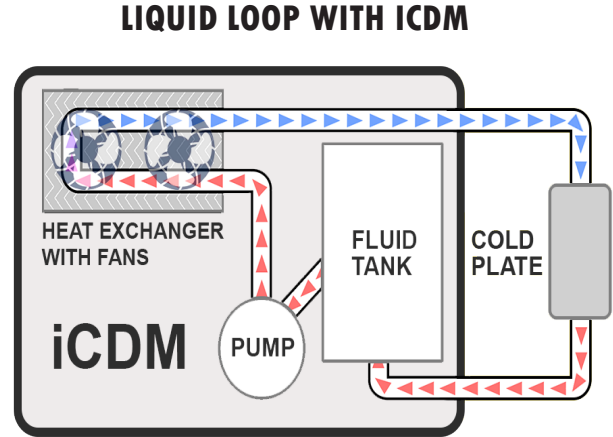
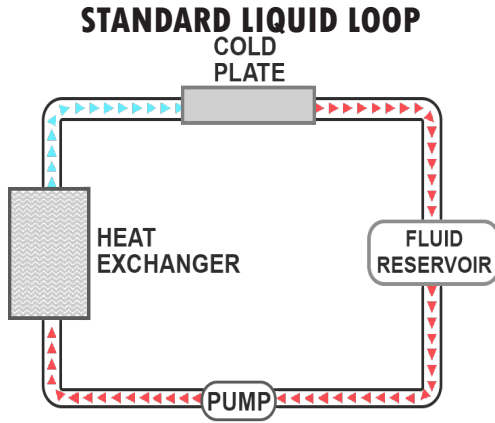

The central image shows a grey and black industrial cooling unit labeled "iCDM-20". Six red and blue lines radiate from the unit to six hexagonal images representing different applications:

- MEDICAL:** Image of an MRI machine.
- BIOTECH:** Image of laboratory flasks being filled.
- FOOD & BEVERAGE PRODUCTION:** Image of a conveyor belt with many red-capped bottles.
- INDUSTRIAL LASER:** Image of a laser cutting through metal, creating sparks.
- MIL/AERO:** Image of a large satellite dish on a mobile trailer.
- SEMICONDUCTOR MANUFACTURING:** Image of a large, colorful, multi-layered circuit board.

Contact us with your custom design requirements @ ats-hq@qats.com